

- KEY:**
- DEVELOPMENT BOUNDARY
  - PROPOSED SITE TRACK

- NOTES:**
1. VEHICLE TRACKING BASED ON 16.5m MAX UK LEGAL ARTICULATED VEHICLE.

- REFERENCES:**
- [1] 04531-RES-ACC-DR-PT-001 - ENTRANCE LAYOUT.

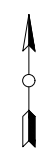
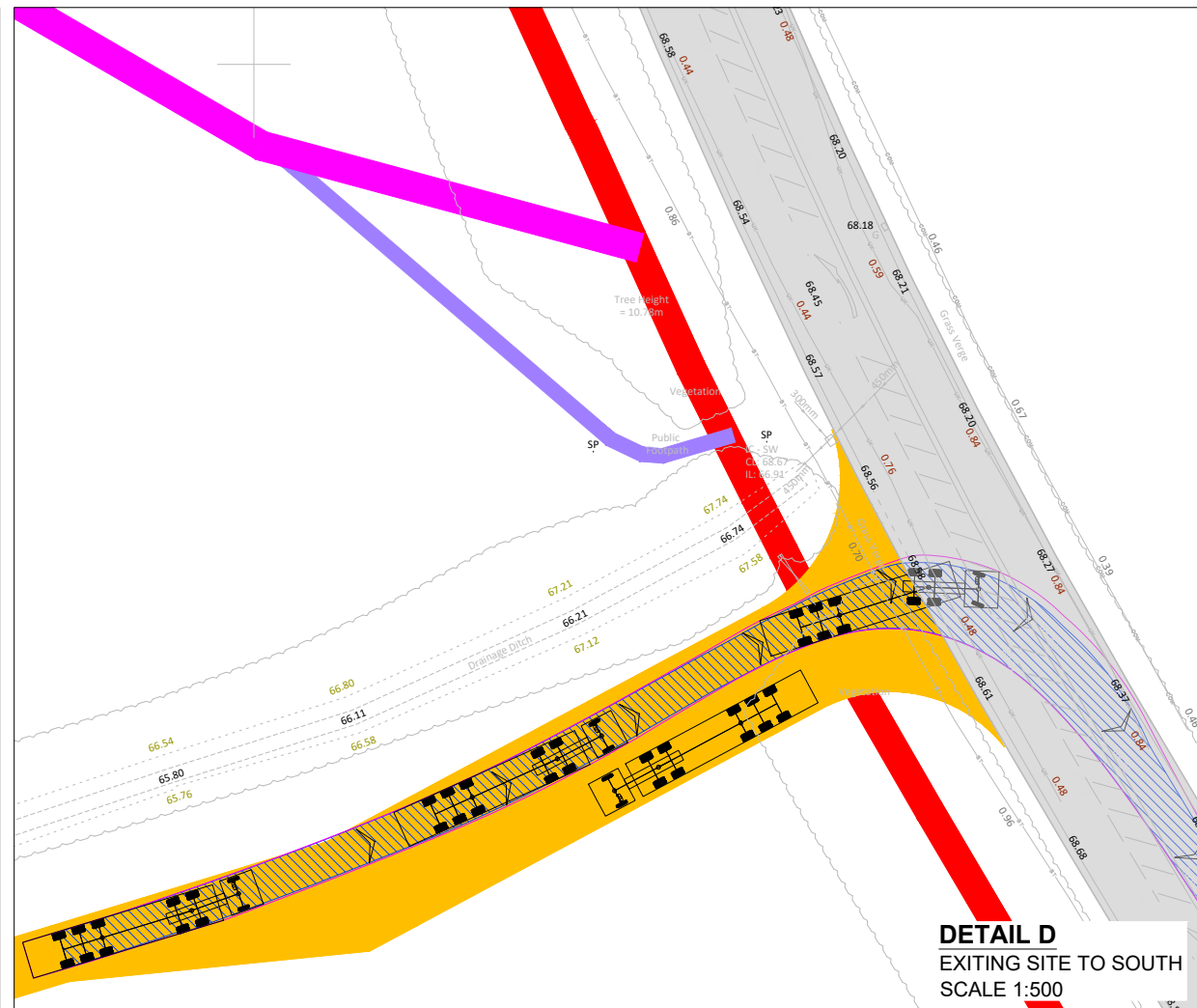
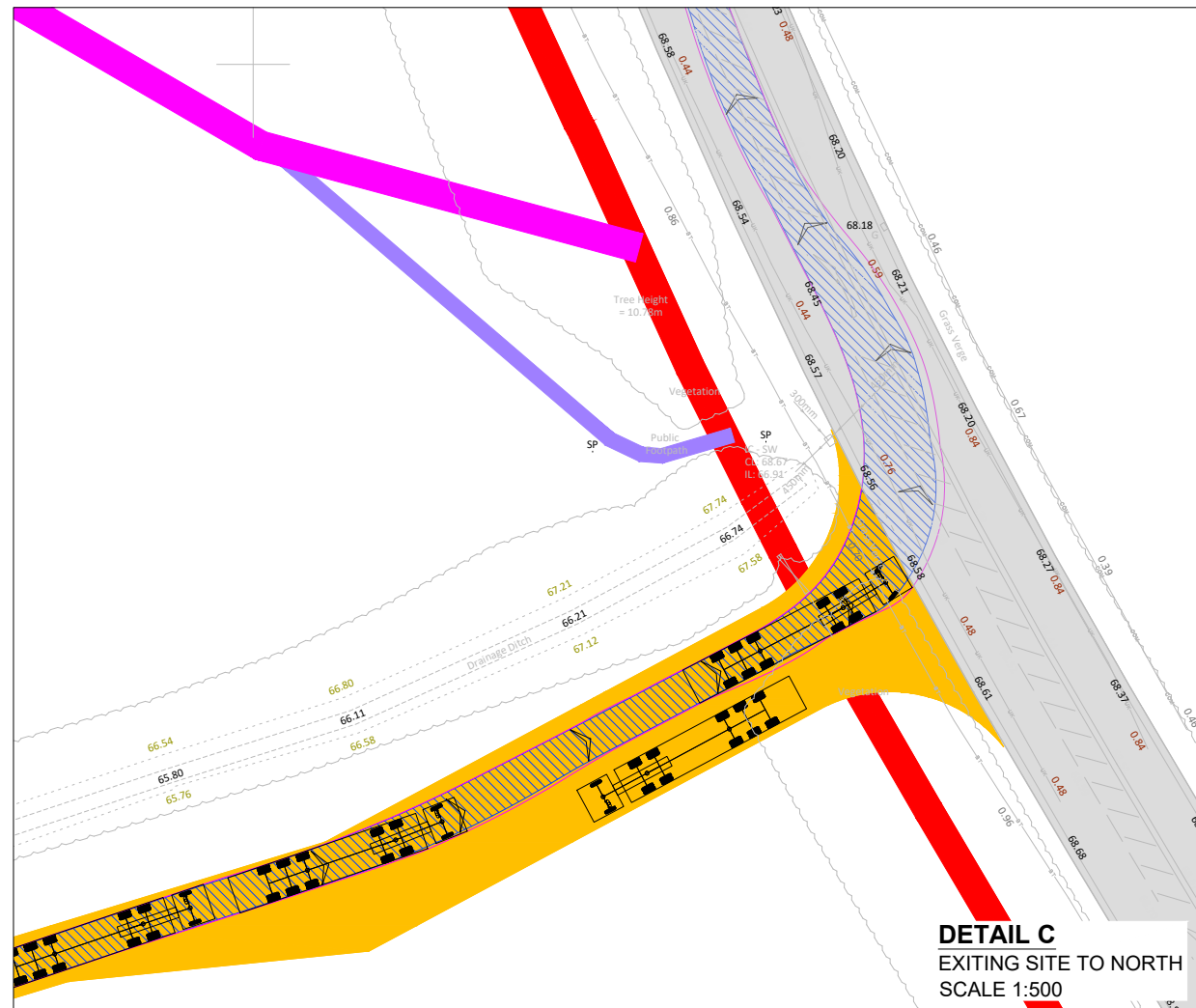
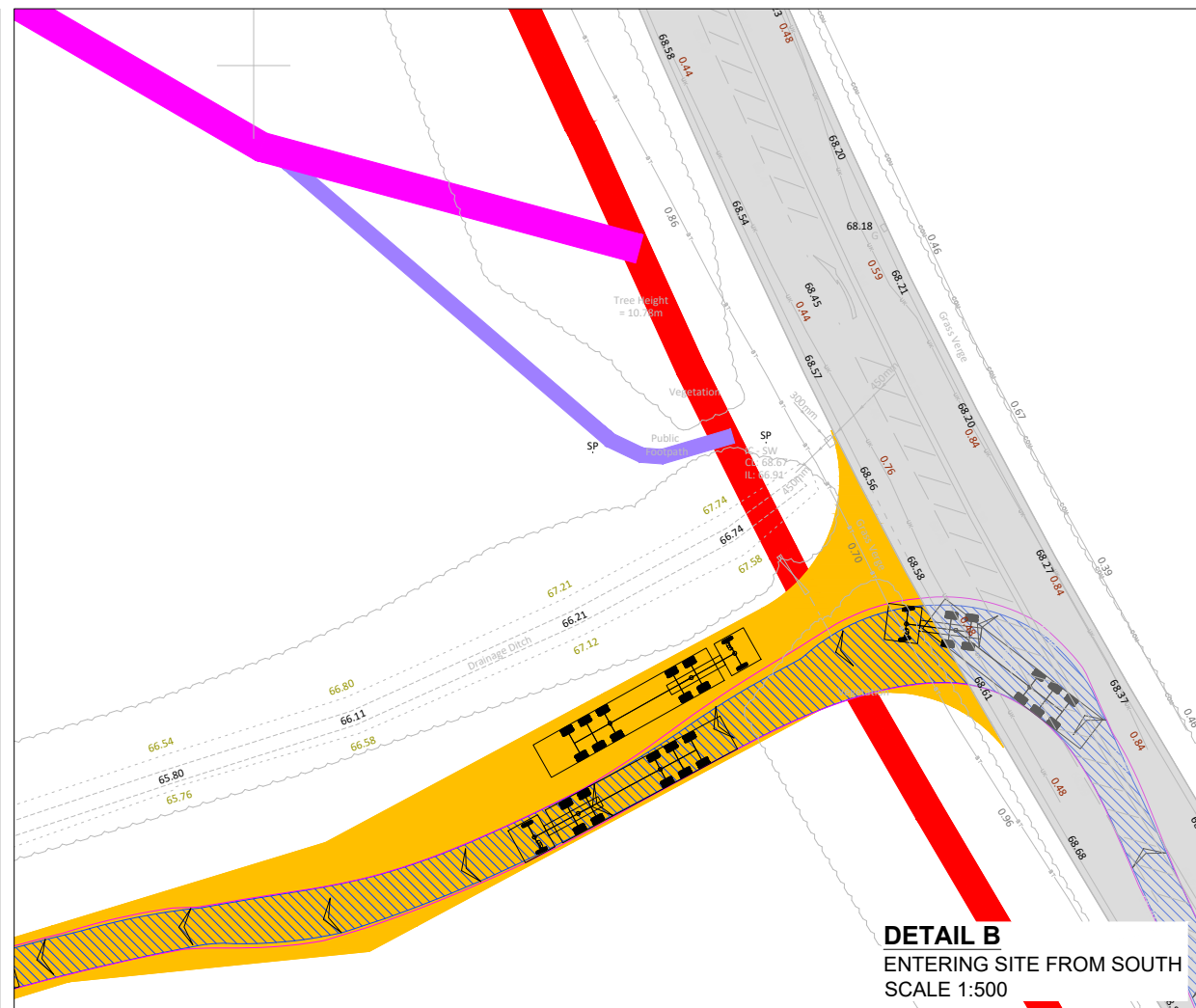
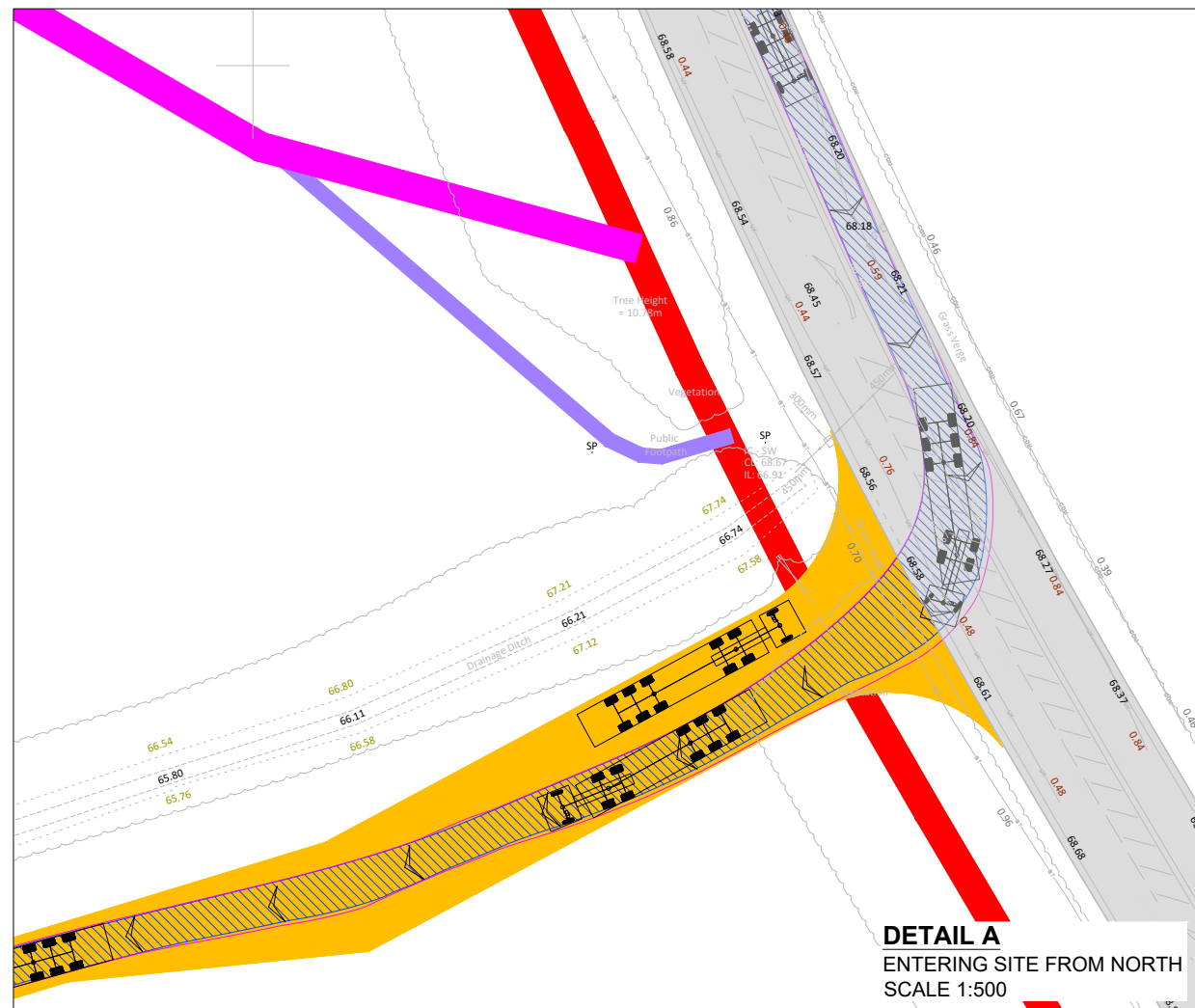

1	FG	BY APPD	JM	2024-08-30	First Issue
ISSUE	DRAWN	CHKD	APPD	DATE	REVISION NOTES
PURPOSE				COORDINATES	
PERMITTING				OSGB 1936	
SCALE				DATUM	
AS SHOWN @A3				N/A	
LAYOUT DRAWING				T-LAYOUT NO	
N/A				N/A	
PROJECT TITLE					
NUNEHAM					
DRAWING TITLE					
FIGURE 18 SITE ENTRANCE TRACKING					
RES DRAWING NUMBER					REV
04531-RES-ACC-DR-PT-002					1
THIS DRAWING IS THE PROPERTY OF RENEWABLE ENERGY SYSTEMS LIMITED AND NO REPRODUCTION MAY BE MADE IN WHOLE OR IN PART WITHOUT PERMISSION					
				BEAUFORT COURT, EGG FARM LANE, KINGS LANGLEY, HERTS WD4 8LR, UK TEL +44 (0) 1923 299200 WWW.RES-GROUP.COM	